

LEGEND	
	PROPOSED PAVEMENT
	PROPOSED CONTOURS (0.5' INTERVALS)
	EXISTING CONTOURS (0.5' INTERVALS)
	PROPOSED CONCRETE FLUME / SLOPE PROTECTION
	PROPOSED BUILDING FOUNDATION BORDER

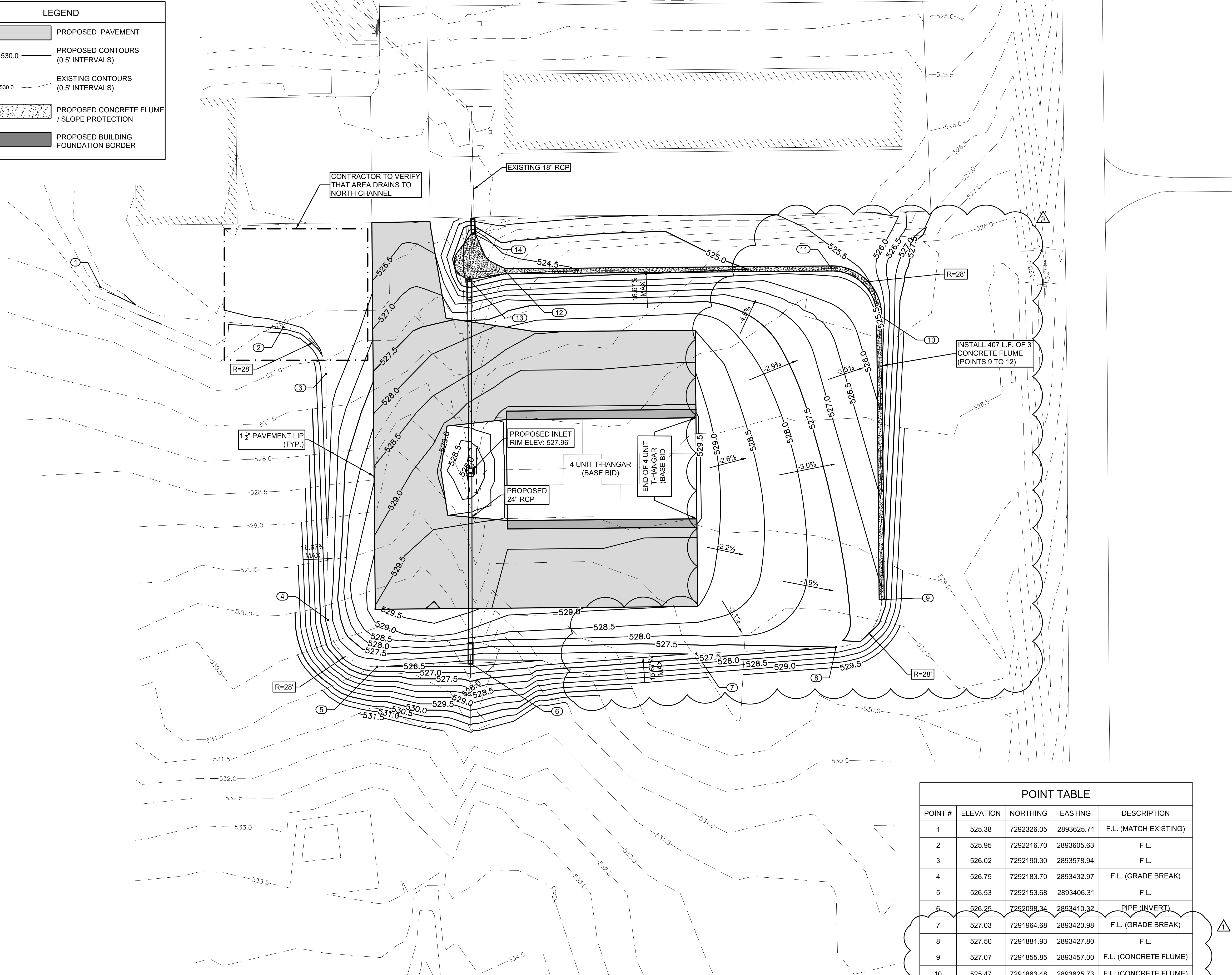

POINT TABLE				
POINT #	ELEVATION	NORTHING	EASTING	DESCRIPTION
1	525.38	7292326.05	2893625.71	F.L. (MATCH EXISTING)
2	525.95	7292216.70	2893605.63	F.L.
3	526.02	7292190.30	2893578.94	F.L.
4	526.75	7292183.70	2893432.97	F.L. (GRADE BREAK)
5	526.53	7292153.68	2893406.31	F.L.
6	526.25	7292098.34	2893410.32	PIPE (INVERT)
7	527.03	7291964.68	2893420.98	F.L. (GRADE BREAK)
8	527.50	7291881.93	2893427.80	F.L.
9	527.07	7291855.85	2893457.00	F.L. (CONCRETE FLUME)
10	525.47	7291863.48	2893625.73	F.L. (CONCRETE FLUME)
11	525.25	7291892.72	2893652.43	F.L. (CONCRETE FLUME)
12	524.26	7292006.27	2893643.68	F.L. (CONCRETE FLUME)
13	524.30	7292107.29	2893637.83	PIPE (INVERT)
14	524.06	7292106.06	2893685.54	PIPE (MATCH EXISTING)

REVISION	DATE
1	08/14/17

REVISED GRADING PLAN

PARIS-COX FIELD AIRPORT
FY 2016 T-HANGAR AND
HANGAR ACCESS
TAXILANE
PARIS, TEXAS

DRAWN BY: JDD	DESIGNED BY: EN	LATEST REVISION: 8/14/2017	KSA JOB NO.: PRS-016
---------------	-----------------	----------------------------	----------------------

KSA ENGINEERS
8875 Synergy Dr., McKinney, Texas 75070
T. 972-542-2995 F. 972-542-6750
www.ksaeng.com

STATE OF TEXAS
CHAD E. PENNEL
11114
ENGINEER'S SEAL AND SIGNATURE ARE FOR THE ABOVE NOTED CHANGES ONLY